



## SR-10 Saddle Roof

The SR-10 Roof consist of a HD/FD34 Ground Support on four HD/FD34 Towers and a Roof Structure of HD/FD34 Truss and Roof Ladder Supports.

The SR-10 Roof is a tower based structure with a saddle roof. This saddle roof has a relative high load bearing HD/FD34 Main Rig with an HD/FD34 roof structure with a fixed angle on the two HD/FD34 gables which enables you to re-build the roof in various dimensions.

As the ground support and additional roof is mainly built out of standard HD/FD 34 elements, only a few special roof parts are required to build a SR-10 Roof. This makes the SR-10 a very attractive and efficient roof system to acquire.

The SR-10 guarantees a good workable load and this combination ensures you of a minimum of trucking and storage space and can be lifted motorized or by manual chain hoists. The SR-10 Roof is designed and calculated to be set up on either single steel or aluminium bases. The top canopy is tightened with tubes and ratchet straps and the wall canopies can be either in full PVC or the wind through mash.

### Specifications

Towers:	FD/HD34
Main Grid:	FD/HD34
Roof Structure:	FD/HD34/32
Size:	10x8, 8x6, 8x4 and 6x4 m.
Options:	PA Wings

### SR-10 Sizes & Loading Metric

SR-10 Saddle Roof	10x8 m. (HD)	10x8 m. (FD)	8x6 m.	6x4m.
User Load Roof UDL:*	1.720	1.150	1.200	640
User Load Roof CPL:*	2.000	1.400	1.400	640
User Load PA frame:*	1.000	1.000	1.000	1.000
Max. Wind Force:**	10 Bft	10 Bft	10 Bft	10 Bft

\*in kg | \*\*Walls (side/back) must be removed if Wind Speed exceeds 72 km/hrs (9bft).

### SR-10 Sizes & Loading Imperial

SR-10 Saddle Roof	33x26 ft.(HD)	33x26 ft. (FD)	26x20 ft.	20x13 ft.
User Load Roof UDL:*	3.792	2.535	2.654	1.411
User Load Roof CPL:*	4.400	3.086	3.086	1.411
User Load PA wing:*	2.200	2.200	2.200	2.200
Max. Wind Force:**	10 Bft	10 Bft	10 Bft	10 Bft

\*in lbs | \*\*Walls (side/back) must be removed if Wind Speed exceeds 72 km/hrs (9bft).

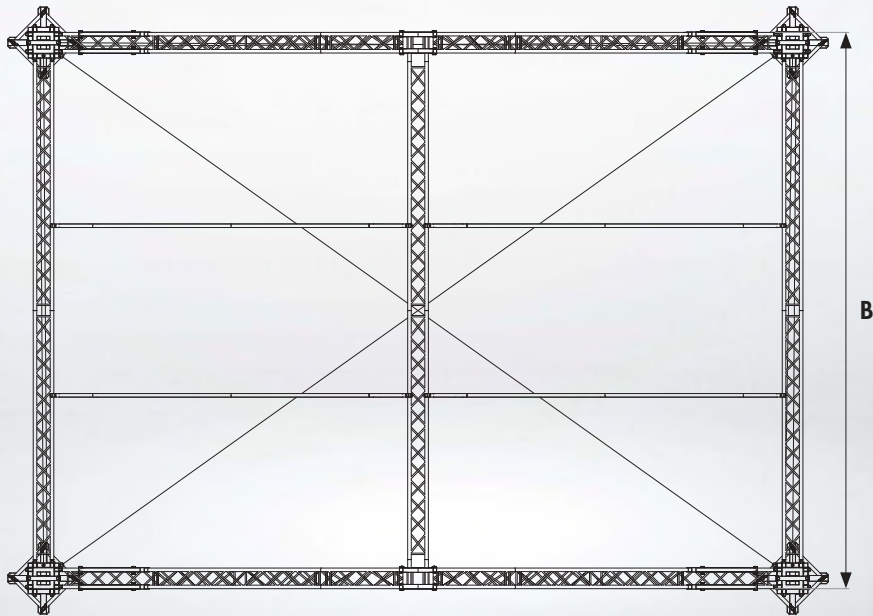
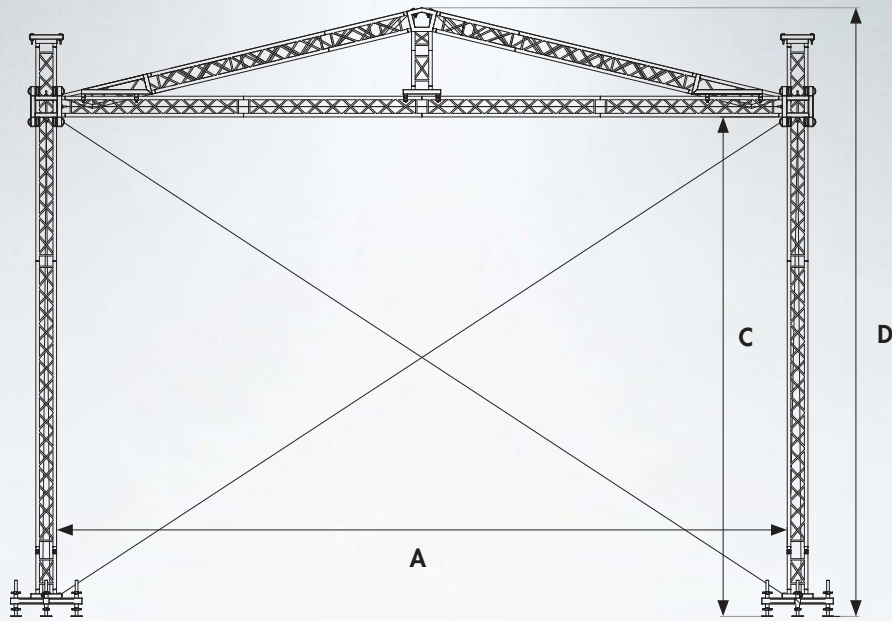

## Dimensions

SR-10 dimensions:*	Metric**			Imperial**		
	10x8 m.	8x6 m.	6x4 m.	32x26 ft.	26x20 ft.	20x13 ft.
<b>A</b> Width	10,2	8,2	6,2	30,6	24,6	18,6
<b>B</b> Depth	7,8	5,8	3,8	23,4	17,4	11,4
<b>C</b> Clearance (side)	7,0	6,0	5,0	21,0	18,0	15,0
<b>D</b> Rooftop Height	8,5	7,3	6,0	25,5	21,9	18,0
Stage area	80 <sup>m2</sup>	48 <sup>m2</sup>	24 <sup>m2</sup>	716 <sup>ft2</sup>	428 <sup>ft2</sup>	212 <sup>ft2</sup>

\* in mtrs | \*\* in feet